



- English -

## Regarding Warranty

Warranty Period : 3 months from date of purchase. This warranty will be void for the following reasons.

- If you are unable to provide both the warranty and the purchase receipt.
- Damages caused by incorrect usage methods or by attempting to fix and/or customize the product.
- Damages caused during delivery, transport or dropping of the product.
- Damages caused by natural disaster.
- This warranty can not cover replacement of parts through natural wear-and-tear.

## For warranty inquiries

Please contact : [global@tenga.co.jp](mailto:global@tenga.co.jp)  
[iroha-tenga.com](http://iroha-tenga.com)

## iroha mini User Manual / Warnings

● Thank you for your purchase of the iroha mini. For the proper and safe use of this item, please read this User Manual before use. The Warranty is also attached to this manual so please store this User Manual in a safe place.

### How to use

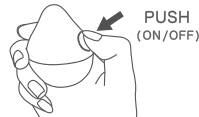

### Storage

- Please keep away from direct sunlight and store in a cool, dry place. Not doing so may cause defects, overheating and fire hazards.
- Please do not store with flammable solvents or oil-based products.

### How to clean

- ① Please wash with tepid water.
- ② If using soap, please use a mild, neutral soap.
- ③ After washing, please dry with a soft towel.
- ④ Do not wash in hot water.
- ⑤ Please do not submerge the product for prolonged periods of time, or boil the product.
- ⑥ Do not use any acidic or alkaline washing agents, alcohol, or corrosive substances to clean the product.

### Changing Battery

- The included battery is to see if the product works. For proper use please replace battery upon first use.
  - When changing battery, please turn the product OFF.
  - Battery life may fluctuate depending on situation and frequency of use. ※ If the product stops working for reasons other than defect, or the vibrations seem dull, please change the battery.
- ① Twist top part counter-clockwise until it clicks out of place. Lift and remove.
  - ② Please be sure to check positive and negative ends of the battery and replace.
  - ③ Replace top part and twist clockwise until it clicks into place.

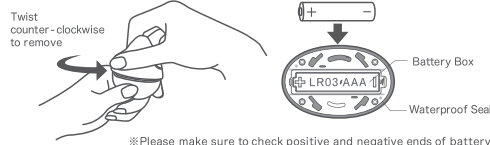

## ⚠ Regarding water-resistance

- Please do not get hair, dirt or other substances trapped inside the Waterproof Seal. These will cause an opening for water to enter the product.
- Please ensure not to damage the Waterproof Seal when changing battery.
- Please make sure to check the Waterproof Seal for damages to prevent possibilities of water entering the product.

## ⚠ Caution

- Please do not use or store the product in direct sunlight or heated environments. This may cause defect, overheating or fire hazards.
- Please only use mild, neutral soap and tepid water to wash the product.
- Please do not submerge the product for prolonged periods of time, or boil the product.
- This product is designed to be water resistant from weak pressures of water flow, but may break when exposed to strong water flow, or when submerged in water deeper than 50cm.
- Please do not use in salt water or seawater. This may cause damage to the product.
- Please do not use acidic, alkaline substances, alcohol or hot water when washing the product. This may cause disfiguration of the shape of the product.
- Please do not use the product if you are under the following conditions: When extremely tired. When under the influence of alcohol.
- Please do not drop or expose product to extreme forces. This may cause electrical short circuiting or defects.
- Please do not use near open flames or cigarettes. This may cause fire hazards.
- If you feel any physical abnormalities during use of the product, please cease use immediately and seek medical attention.
- If you find any damages or defect with the product, please cease use immediately and turn the power OFF. Use of damaged product may cause injury.
- Always turn product OFF after use to prevent accidents or injury.

## ⚠ WARNING

- Wash before first use and after every use.
- Those with pacemakers or other electronic medical devices, pregnant, or otherwise currently receiving medical treatment, please discuss use of this item with a medical professional before use.
- Do not expose to water if the product is loose or the battery box is exposed.
- Do not use on any areas of the body that are irritated, inflamed or otherwise damaged.
- Keep out of reach of children. Product contains small parts that may be accidentally swallowed.
- Do not attempt to deconstruct, modify or fix the item yourself. This may cause fire hazards and injuries.
- To prevent transfer of STIs, do not share.
- Do not use on same area of body for over 15 minutes.
- Use only water-based lubricants with this product.

## ⚠ Regarding Battery

- Please use only Alkaline AAA batteries with this product. Non-alkaline batteries may cause extreme shortening of running time.
- Always read safety information of the battery.
- Do not expose battery to fire, short circuit battery or attempt to deconstruct the battery.
- Do not expose battery to water.
- Always ensure positive and negative ends of the battery.
- Remove dead batteries immediately.
- If you are not using the product for a prolonged period of time, remove battery.
- If you are exposed to liquid from the battery, please wash area exposed and seek medical attention.

## Product Specifications

Product Name and Item Code	FUJI-LEMON hmm - 01
	UME-ANZU hmm - 02
	SORA-MIKAN hmm - 03
Running time	Approx. 5 hours
Product size/Weight	61 x 52 x 34mm / Approx 61g
Materials	Elastomer, ABS, AAA Alkaline Battery
Country of manufacture	China

## Product Warranty

Name:	
Address:	
Telephone Number:	
Warranty Period:	3 Months
Date of Purchase:	
Place of Purchase: (Name of Store, Address, Telephone Number) Attach Receipt	

HMM01P01 - 10

